

Crawford County Real Estate, Inc.

1203 W. Main

Robinson, IL 62454

Phone: (618) 544-8605 - FAX: (618) 544-9335

www.crawford-county.com (web site) ** ccre@crawford-county.com (email)



Owner: Roth Enterprises

Listed by: Gayle McKee

Legal: Courtyard Addition, Block A, Lot #12

Zoned: DD Taxes: \$405.56 ' 10

Lot Size: 100' street x 120' deep

Location: 1307 W. Mefford
Robinson, IL 62454

Price: **\$20,000**

#05-1-28-300-013-000

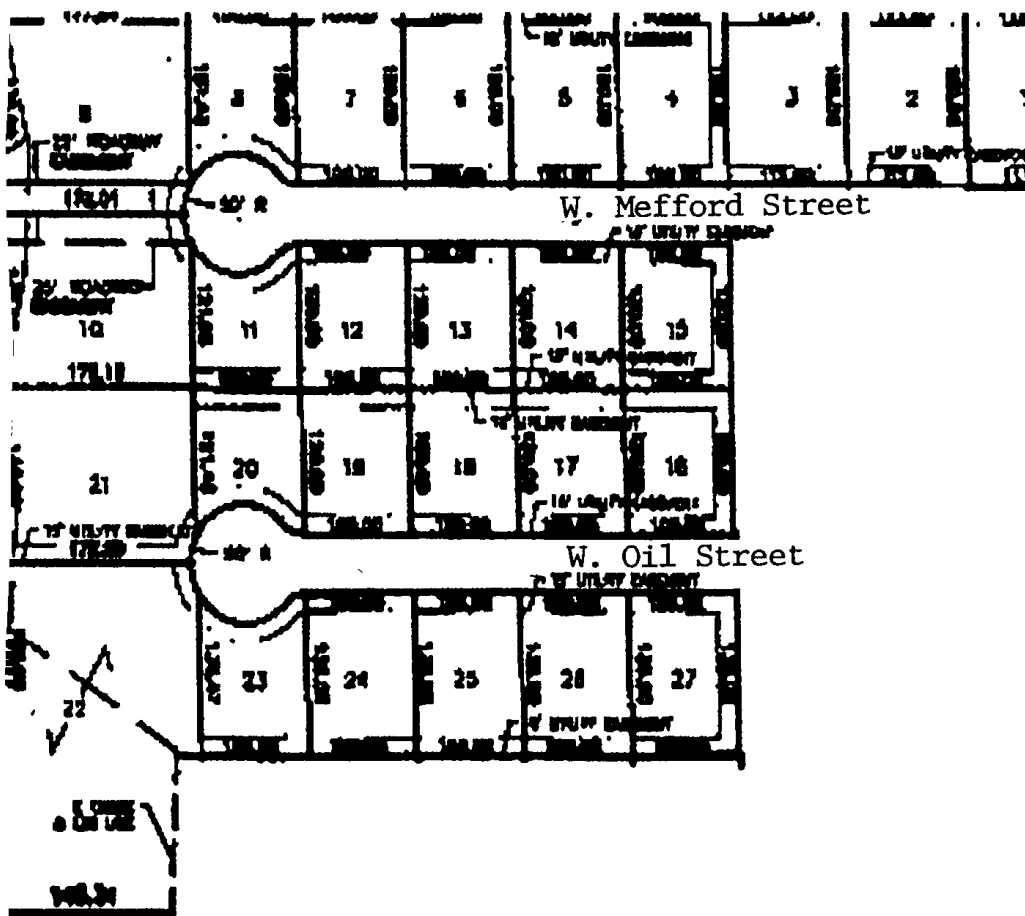

All information is believed correct, but not guaranteed.